



## MCMILLAN COURT CUMBERLAND PLACE

LONDON, SE6 1LA

**£215,000**  
LEASEHOLD

A well-presented one-bedroom first floor apartment, ideally positioned within Cumberland Place. Offering a bright and practical layout, this property is perfect for first-time buyers or professionals seeking a conveniently located home. Further benefits include residents' off-street parking, a communal garden, and the added advantage of being offered to the market with no onward chain.

Internally, the property comprises a spacious reception and dining room, providing a comfortable and versatile living area with plenty of room for both relaxing and entertaining. The separate kitchen is well arranged with good workspace and storage. The double bedroom is generously proportioned, while the bathroom is fitted with a full-sized bath and overhead shower. The overall layout is well balanced, making excellent use of the available space.

**DouglasPryce**

# Cumberland Place, SE6 1LA

Approx Gross Internal Area = 30.66 sq m / 330 sq ft

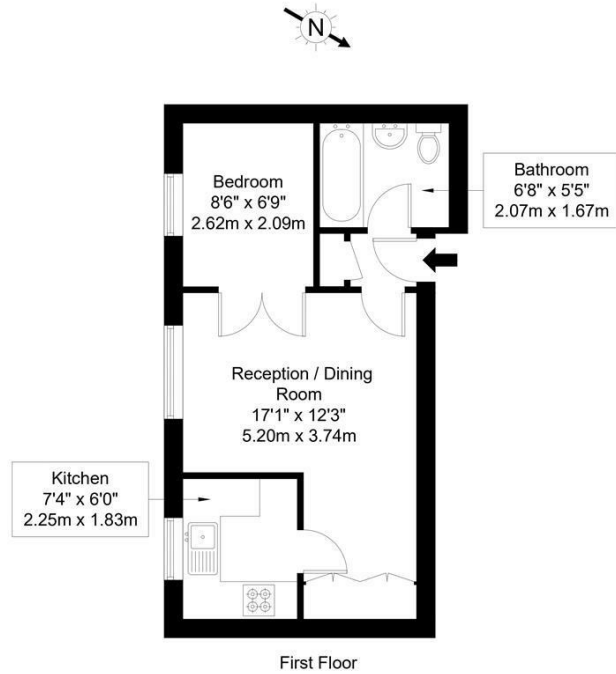

Ref :

Copyright **BLEU PLAN**

The Floor plan is not to scale and measurements and areas shown are approximate and therefore should be used for illustrative purposes only. The plan has been prepared in accordance with the RICS code of Measuring Practice and whilst we have confidence in the information produced it must not be relied on. Maximum lengths and widths are represented on the floor plan. If there is any aspect of particular importance, you should carry out or commission your own inspection of the property.  
Copyright @ BLEUPLAN



Energy Efficiency Rating		
	Current	Potential
Very energy efficient - lower running costs		
(92 plus) <b>A</b>		
(81-91) <b>B</b>		
(69-80) <b>C</b>	73	74
(55-68) <b>D</b>		
(39-54) <b>E</b>		
(21-38) <b>F</b>		
(1-20) <b>G</b>		
Not energy efficient - higher running costs		
<b>England &amp; Wales</b>	EU Directive 2002/91/EC	

Agents Note: Whilst every care has been taken to prepare these particulars, they are for guidance purposes only. All measurements are approximate and are for general guidance purposes only and whilst every care has been taken to ensure their accuracy, they should not be relied upon and potential buyers/tenants are advised to recheck the measurements

Sales  
Verdant Lane  
London  
SE6 1LF

07887933642  
glenn@douglaspryce.co.uk  
www.douglaspryce.co.uk

**DouglasPryce**